

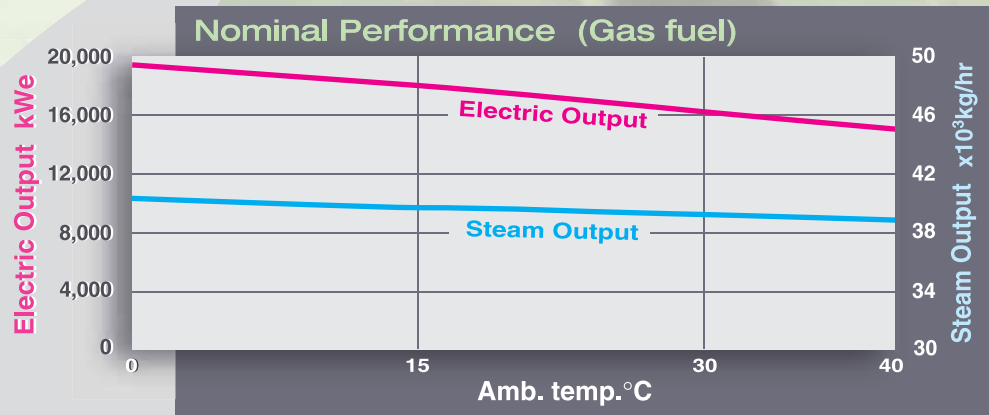

High efficiency : electric 33.7%, overall 84.0%
Dry low emissions : NOx 15ppmv, CO 50ppmv (O₂ = 15%)
High reliability & easy maintenance



Amb. temp. °C (°F)	Electric Output kWe	Heat Rate kJ/kW-hr	Steam Output x10 ³ kg/hr	Electrical Efficiency %	Total Thermal Efficiency %
0 (32)	19,320	10,500	40.2	34.3	82.5
15 (59)	17,970	10,690	39.7	33.7	84.0
40 (104)	15,080	11,380	38.8	31.6	86.7

Nominal Performance

Elevation : 0 m
Inlet Air Temperature : 15 °C
Inlet Air Pressure Loss : 0.98 kPa
Exhaust Gas Pressure Loss : 2.45 kPa
LHV of Natural Gas Fuel : 35.9 MJ/Nm³
(100% CH₄)

Typical Steam Condition

Steam Pressure : 0.83 MPaG
Steam Temperature (Saturated) : 177 °C
Feed Water Temperature : 80 °C
Blowdown from HRSG : 0 %

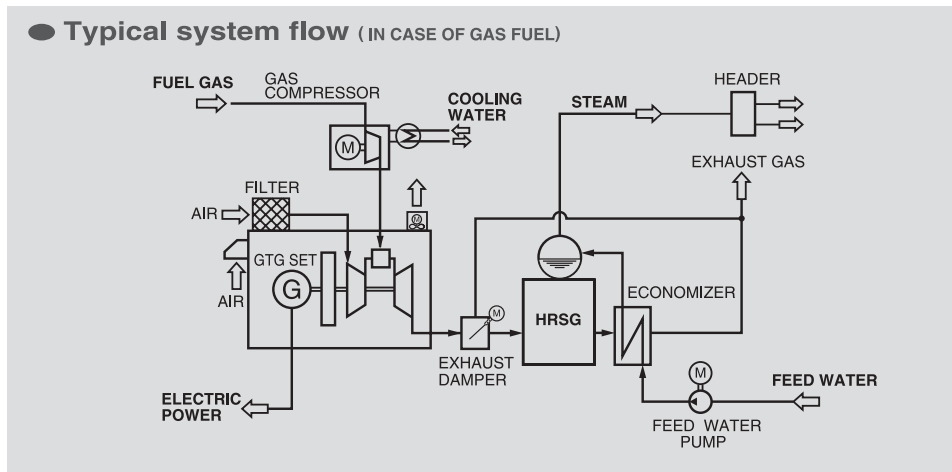

● Typical layout (Unit:mm)

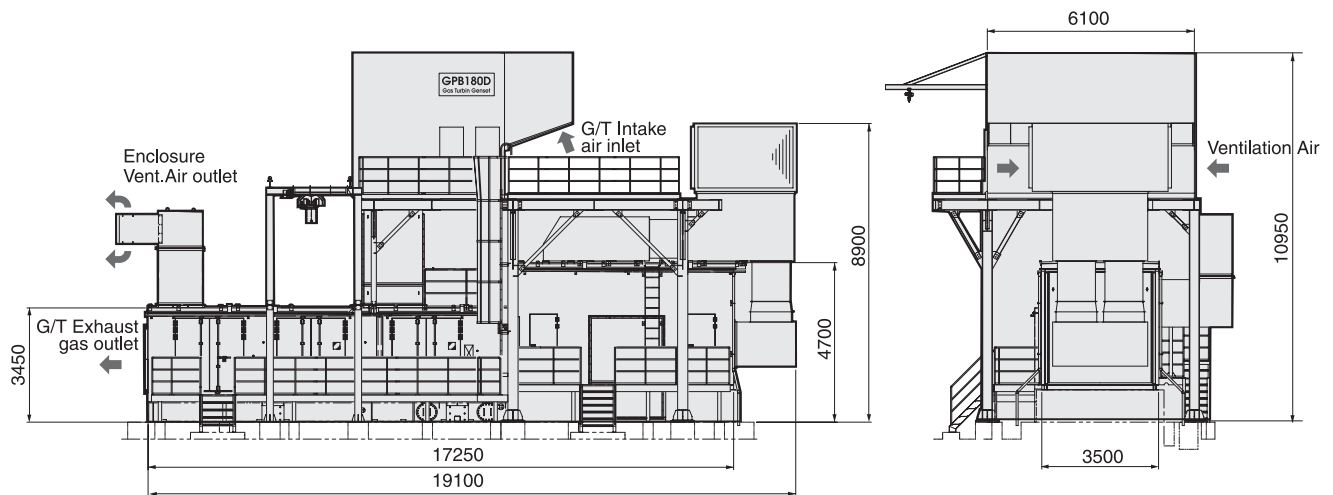

www.khi.co.jp/english/gasturbine/index.html

Kawasaki Heavy Industries, Ltd. Gas Turbine Division

Phone: +81-3-3435-2579 Fax: +81-3-3435-2592

Kawasaki Machine Systems, Ltd. (Asia Division)

Phone: +81-3-3435-2977 Fax: +81-3-3435-2592

Kawasaki Gas Turbine Asia Sdn Bhd : (KGA)

Phone: +60-3-7846-2882 Fax: +60-3-7848-3093

www.kga.com.my

Kawasaki Gas Turbine Europe GmbH : (KGE)

Phone: +49-6172-7363-0 Fax: +49-6172-7363-55

www.kawasaki-gasturbine.de

Kawasaki Gas Turbines-Americas : (KGT-A)

Phone: +1-281-970-3255 Fax: +1-281-970-6465

www.kawasakigasturbines.com

Kawasaki Machine Systems, Ltd. (Shanghai Rep.Office)

Phone: +86-21-3366-3500 Fax: +86-21-3366-3505

Kawasaki Heavy Industries Middle East FZE : (KHI-ME)

Phone: +971-4-214-6727 Fax: +971-4-214-6729

Kawasaki Gas Turbines-Americas
(Houston, TX)

Kawasaki Gas Turbine Europe GmbH
(Frankfurt, Germany)

Kawasaki Heavy Industries, Ltd.
(Tokyo, Japan)

Kawasaki Machine Systems, Ltd.
(Shanghai Rep. Office)

Kawasaki Heavy Industries
Middle East FZE
(Dubai, UAE)

Kawasaki Gas Turbine Asia Sdn Bhd
(Shah Alam, Malaysia)

