

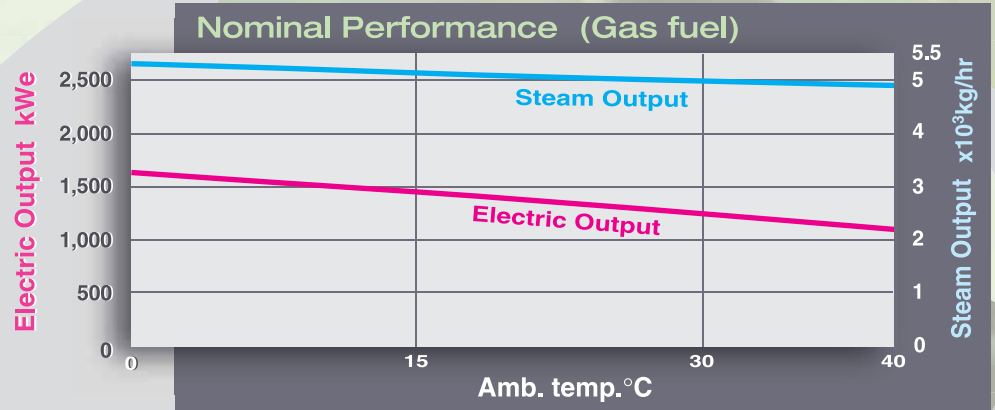

High efficiency : electric 23.6%, overall 79.7%
 Dry low emissions : NOx 25ppmv, CO 50ppmv (O₂ =15%)
 High reliability & easy maintenance



Amb.temp. °C (°F)	Electric Output kWe	Heat Rate kJ/kWe-hr	Steam Output x10 ³ kg/hr	Electrical Efficiency %	Total Thermal Efficiency %
0 (32)	1,630	14,810	5.3	24.3	77.8
15 (59)	1,450	15,280	5.1	23.6	79.7
40 (104)	1,116	17,140	4.9	21.0	82.8

Nominal Performance

Elevation : 0 m
 Inlet Air Temperature : 15 °C
 Inlet Air Pressure Loss : 0.98 kPa
 Exhaust Gas Pressure Loss : 2.45 kPa
 LHV of Natural Gas Fuel : 35.9 MJ/Nm³
 (100% CH₄)

Typical Steam Condition

Steam Pressure : 0.83 MPaG
 Steam Temperature (Saturated) : 177 °C
 Feed Water Temperature : 80 °C
 Blowdown from HRSG : 0 %

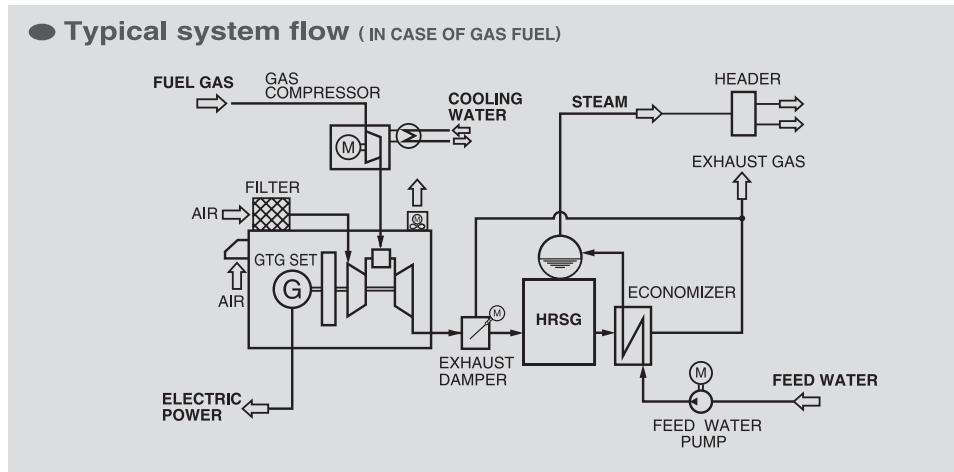

● Typical layout (Unit:mm)

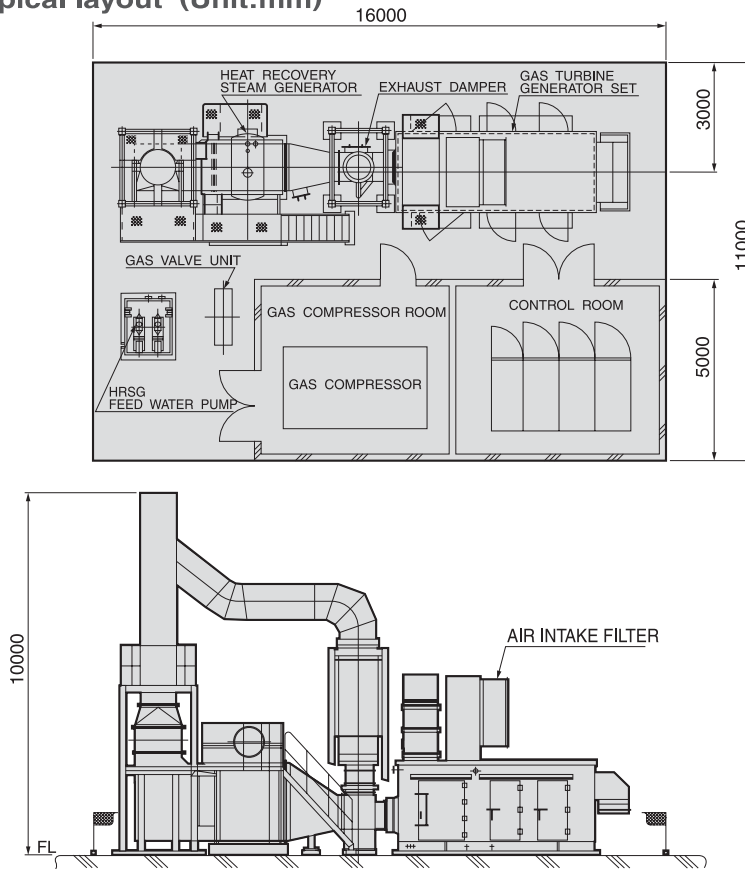

www.khi.co.jp/english/gasturbine/index.html

Kawasaki Heavy Industries, Ltd. Gas Turbine Division

Phone: +81-3-3435-2579 Fax: +81-3-3435-2592

Kawasaki Machine Systems, Ltd. (Asia Division)

Phone: +81-3-3435-2977 Fax: +81-3-3435-2592

Kawasaki Gas Turbine Asia Sdn Bhd : (KGA)

Phone: +60-3-7846-2882 Fax: +60-3-7848-3093

www.kga.com.my

Kawasaki Gas Turbine Europe GmbH : (KGE)

Phone: +49-6172-7363-0 Fax: +49-6172-7363-55

www.kawasaki-gasturbine.de

Kawasaki Gas Turbines-Americas : (KGT-A)

Phone: +1-281-970-3255 Fax: +1-281-970-6465

www.kawasakigasturbines.com

Kawasaki Machine Systems, Ltd. (Shanghai Rep.Office)

Phone: +86-21-3366-3500 Fax: +86-21-3366-3505

Kawasaki Heavy Industries Middle East FZE : (KHI-ME)

Phone: +971-4-214-6727 Fax: +971-4-214-6729

**Kawasaki Gas Turbines-Americas
(Houston, TX)**

**Kawasaki Gas Turbine Europe GmbH
(Frankfurt, Germany)**

**Kawasaki Heavy Industries, Ltd.
(Tokyo, Japan)**

**Kawasaki Machine Systems, Ltd.
(Shanghai Rep. Office)**

**Kawasaki Heavy Industries
Middle East FZE
(Dubai, UAE)**

**Kawasaki Gas Turbine Asia Sdn Bhd
(Shah Alam, Malaysia)**

